

1.1

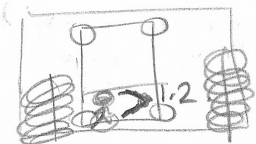

1.2

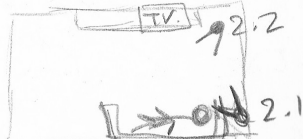

2.2

2.1

SHOT LIST

SCENE 1 (CAR WASH)

- ①-1) XCU brushes in car wash (we can't tell what it is) the brushes open to reveal this woman's face sitting in car motionless (camera on tripod - outside car) - sounds of car wash outside.
- ①-2) CU of woman (from side - from co-driver's seat) as she is sitting in the car wash - Sound of seatbelt beeping - Her phone rings - she is anxious - she answers - (steady shot) - She speaks (voice recording)

SCENE 2A (TV ROOM - ~~ATTN~~ KITCHEN)

- ②-1) MS - TV (from next to woman's head on sofa while sleeping)
 colour showing
 we can't see the woman
 (sound of beep) - connected with previous scene
 woman wakes up & sits up to fill most of shot - (background - in bedroom)
- ②-2) CU - woman's face looking at TV (sweating from nightmare) she sits up (camera follows checks her movements)
 she moves to the TV - switches it off & leaves the room

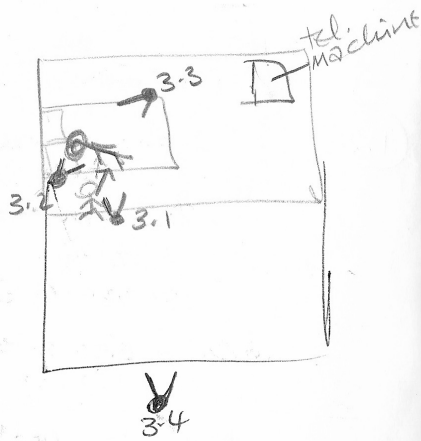
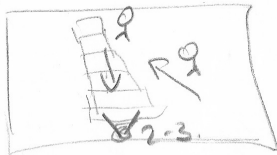

SCENE 25 - STAIRS
 (26.1) MS - her walking up the stairs (shot from under the stairs)

SCENE 3 (BEDROOM)
 (3.1) MS - (she is holding her phone.) - woman's legs walking towards bed & lying down - we see her back - she turns - we see her - she takes the quilt from the other end & covers herself. - phone rings - machine.

(3.2) MCU - she sits up & listens to the message (focus on answering machine)

(3.3) CU - she looks at the photo that they are together - listening to the message.

(she can't sleep from ^{similar} different angles) fast cuts. to 3.1.

she is turning in bed. jump cuts. on a up to after.

(3.4) LS of her sitting in bed listening to the message.

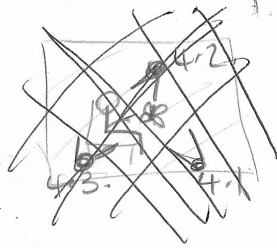
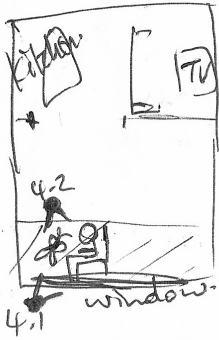

up to here all shots apart from scene 1 are handheld but more stylized and not so shaken -
 from here on - more movement of camera (faster) and closer shots

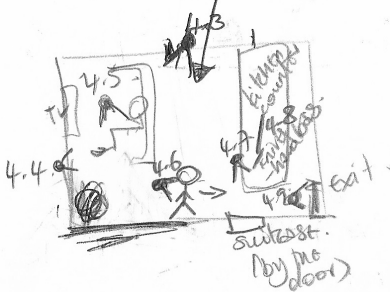

SCENE 4A (TV ROOM / KITCHEN)

- (4.1) MCU of woman's face as she is watching the butterfly (from outside of window) - kitchen/TV room in background
- (4.2) MCU (from inside) of woman's face as she rings phone - sees message + gets up.

Jump cuts quick cuts desk camera

- (4.3) MCU (camera following her) from chair to sofa where shoes are.
- (4.4) MCU (shoes + tilt up as she wears them - stays on her face)
- (4.5) MCU her face (camera follows her to look under the sofa - takes the bag).
- (4.6) MCU behind her shoulder as she fixes her clothes + moves to the suitcase - tilt down to see suitcase.
- (4.7) MCU - handbag as she grabs it & tilt up to see her face looking at the knives

Jump cuts.

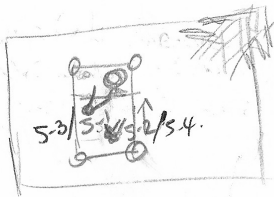

5.5 LS - car moving from Analiontas left to right in rural road.

5.6 LS - car moving from Analiontas left to right in rural road from 5.2 position

4.8 MCU - from 4.7 angle to see the knife as she grabs it.

4.9 MCU over her shoulder as she opens the door & gets out - we see her looking at the house through the door (from inside).

SCENE 5 (MEN ROAD)

5.1 MCU - woman driving (face) (2 takes) car in back seat going + back. she looks at plastic bag & her phone.

SCENE 5 (ANALIONTAS ROAD)

5.2 ~~MCU~~ CU - middle mirror (woman's face (out of focus road in front) camera turns to show plastic bag + hangbag - she speaks on the phone.

5.3 CU woman's face - she sees petrol station (focus on petrol station) - she goes in (we see Demas) from 5.1 position

5.4 MLS - petrol station as she turns (over her shoulder) to it

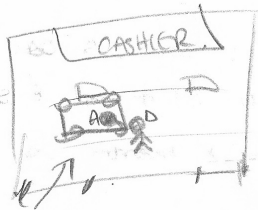

6.1

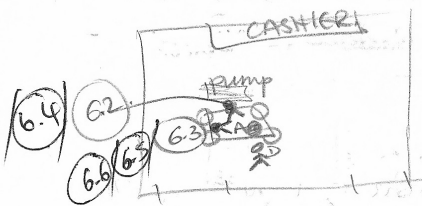

6.25 MCU of woman's hand hiding the bag. (from 6.3 position)

SCENE 6 (PETROL STATION (OUTSIDE) AT PUMPS)

6.1 LS of woman's car entering the petrol station & stopping - Demas moves to her window.

6.2 Woman MCU as she pushes the button to open the petrol tank door (we see Demas body from the window) - "Einoe zo" (he puts his head down to look at her).

6.3 MCU (from left mirror) Demas whistling + putting petrol.

6.4 (from 6.2 position) CU of woman's hand looking at map on her phone - message beeps - tilt up to her face (anxious).

6.5 (from 6.3 position) Woman's hand as she rubs her finger & looks at the guy whistling (tilt up to see him in the mirror)

6.6 MCU (from left mirror) Demas finished putting petrol "Goyin karkda" (from 6.3 position) pan right to woman's MCU getting her hand bag

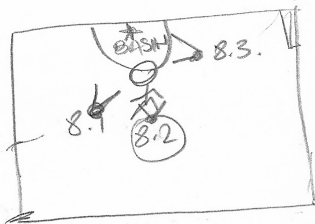
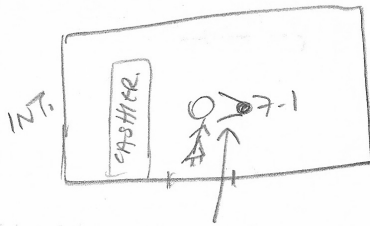
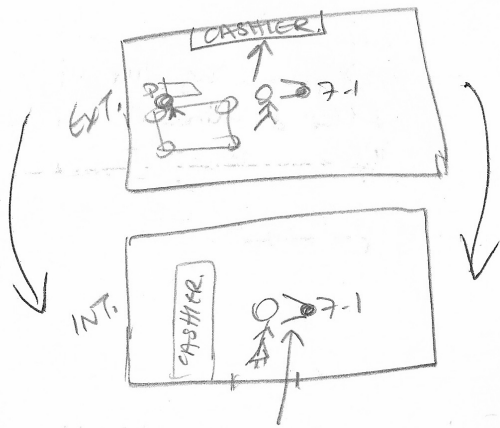
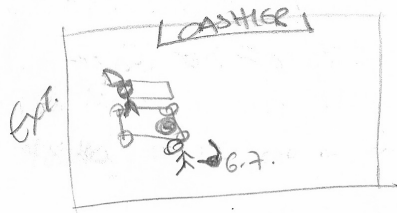

and getting out of the car + locks it

(6.7) MCu of her face as she locks the car and ^{she} leaves the shot
(~~focus on Dennis whistling at her~~)

SCENE 7 - INSIDE BUILDING (PETROL STATION).

(7-1) MCu (camera moving next to her) showing her face as she walks & enters the building
"H zovadiaz" Camera stays on cashier - she exits the frame "Ezo bados"

SCENE 8 - TOILET

(8.1) CU of her hands washing as she puts water on her face - TILT UP to see herself in the mirror - she watches her self-still. Suddenly she puts hair down

(8.2) CUs from various angles as she deconstructs her hair.

(8.3) ~ XCu.

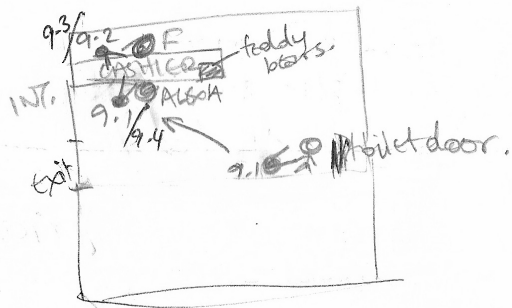

SCENE 9 - AT CASHIER'S

(9.1) MCU of woman as she closes the toilet door & moves to the cashier's (camera turns to FROS) "52 Euros pls"
 - camera turns to her (cu face) as she looks at teddy bears

(9.2) CU of teddy bears
 - camera turns to her face as she grabs one (follow her hand)

(9.3) (from same position as 9.2)
 CU of her face "era na celo zoya"
 - camera stays on her while fros talks "Mapea"
 - she looks at cigarettes

"Ou iara" CU on her
 (9.4) CU - she turns & grabs a lighter (from 9.1 position).
 she opens her bag & takes out cash -
 camera turns to fros, as he says end total €63.60

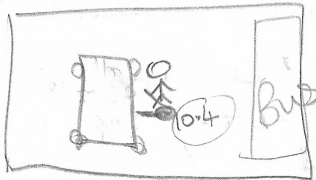
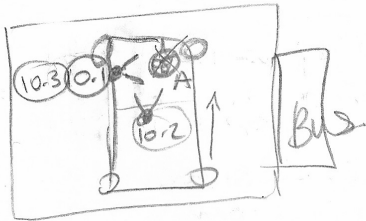

SCENE 10 - ROAD ^{TOWARDS} ~~OUTSIDE~~ BUS.

- 10.1 CU of woman driving - profile (camera next to her) she sees the sheep & slows down.
- 10.2 MS of sheep crossing the road (woman's face is seen out of focus from the side) she turns towards the bus.
- 10.3 CU of woman looking at bus - seeing shepherd going behind it (from 10.1 position) she looks in middle mirror checking if somebody is coming
tilt down to her hand quickly opening the door
- 10.4 CU of her getting out of the car
- 10.5 CU (over her shoulder) as she runs to the bus
- 10.6 CU of her hand grabbing the jacket & running back to the car (camera following her).

Jump cuts

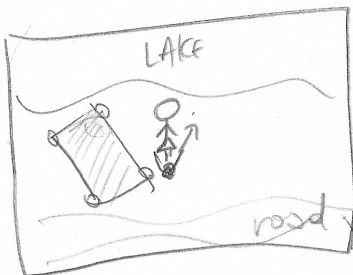
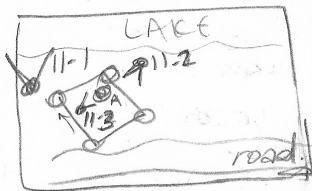
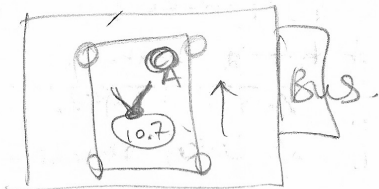

10.7 MCu (through middle mirror)
of Alexia driving away

SCENE 11 (BY THE LAKE)

11.1 LS of lake at magic hour

11.2 CU of woman's face (from
outside the window - she is
thinking - A text message beeps -
she sees it "Eoravunon SE
20 Renza" (magic hour)

11.3 CU of her hand getting the
cigarettes & lighting one
+1/4 up (in the background we see
the lake) (magic hour)

SCENE 12

12.1 MS woman's head (from the
back) as she walks towards
the lake - she stops looks
at the lake a bit
she crouches down & pees.
- we see her head
(magic hour).

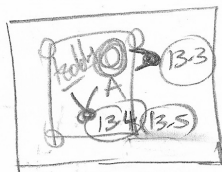
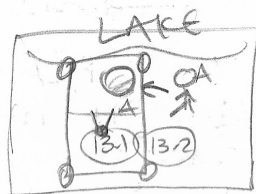

SCENE 13 (FORREST-CAR-NIGHT)

- (13.1) MCU of Alexia as she enters the car (from middle mirror)
tilt down to check phone.
- (13.2) MCU of Alexia turning to look at the teddy bear
- (13.3) MCU of teddy bear as she takes it and pulls the string - she puts it in her arms (follow teddy) - tilt up to show her face. she rocks it & string stay on her face
- (13.4) MCU of teddy in her arms as we see lights coming from the middle mirror (tilt up to see them). she fixes the mirror and from her face it goes to the car.
- (13.5) CU of her hand getting the knife - (same position as 13.4) (in background we can see the teddy bear)

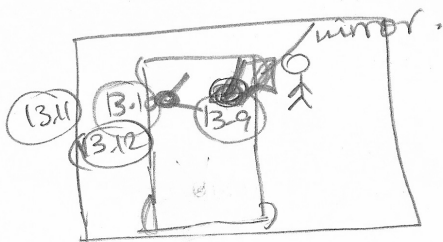
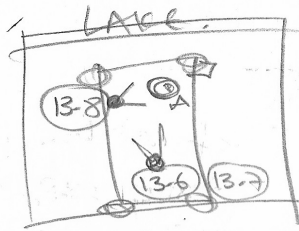

(13-6) XCU of her face from middle mirror (she is sweating)

(13-7) MS of her leaning to get the plastic bag. (camera follows her)

(13-8) MCU of her face as she is waiting for them.
- tilt down to see knife & bag.

(13-9) CU of mirror
(man coming towards her) silhouette. (POV).

(13.10) MCU of woman's face sweating

(13.11) XCU of her hand holding the knife

(13.12) NSU (low angle) - Yiannis arrives by the window "εξέως τα δεξιά" - focus on her to nod & show the bag - He tries to take it - she pulls back.

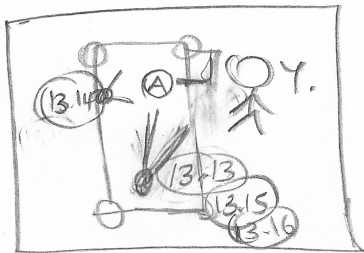

— "Na'zo Sw npiwa"

- 13.13 MCU of Yiannis nodding to guy in car (Alexia's head is seen out of focus on the left)
- 13.14 CU of Alexia's face as she tries to see from mirror (trying . . .)
- 13.15 XCU of right mirror (man holding basket and coming towards car)
- 13.16 CU of back of Woman's head as she tries to see from the middle mirror - focus on her face as she turns to look at the man bringing the basket.
- 13.17